

Single-phase cast resin isolation transformers in IP54 enclosure, finished in anti-flash varnished to supply halogen spotlights for swimming pools and gardens with copper screen between primary and secondary.



Technical characteristics

Rating	100 VA
Input voltage	230 V
Output voltage	12,5 - 13 - 13,5 V
Frequency	50/60 Hz
Protection degree	IP-54
Cooling	ANAN
Ambient temperature	45 °C
Temperature rise	Class B - 130°C
Insulation	Class H - 180°C
Windings	Class HC - 200 °C
Test voltage	3 kV (1 min, 50 Hz)
Standards	IEC/EN/UNE-EN 61558, CE
Mounting	Screws
Weight	3,9 kg

Electric scheme

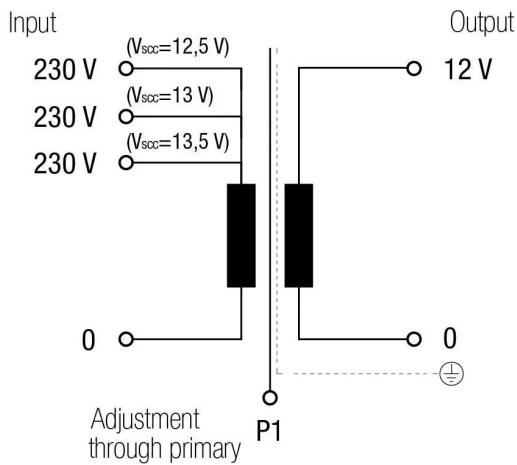

Dimensions

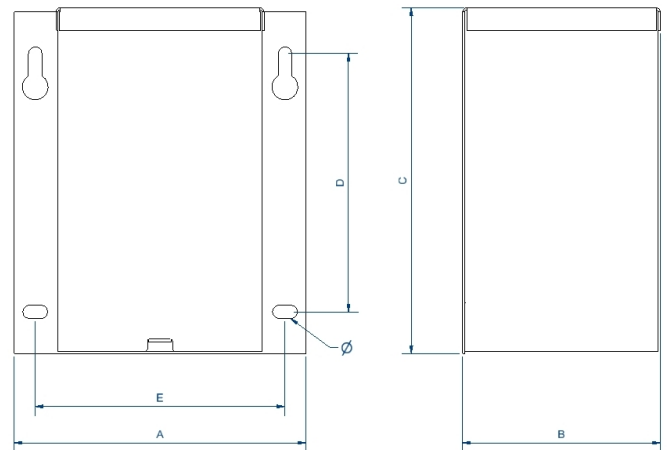

Dimensions (AxBxCxDxE): 140x95x165x123x120 mm 6Ø

Electrical connection

1	2	3	4	5	6	7
0V	30m	20m	10m		0V	12V
Entrada		230V				
POLYLUX®		100 VA		50 - 60 Hz		
				EN 61558		
S.N.:XXXXXX		PIPZ100				
PRECAUCIÓN: CONECTAR TENSIÓN DE ENTRADA ENTRE TERMINALES 1-2 o 1-3 o 1-4						

PIPZ 100

Input:

- 230 V (distance between spotlight and transformer 30 meters)
- 230 V (distance between spotlight and transformer 20 meters)
- 230 V (distance between spotlight and transformer 10 meters)

- Connection: 1-2
- Connection: 1-3
- Connection: 1-4

Output:

12 V

Connection: 6-7

Single-phase cast resin isolation transformers in IP54 enclosure, finished in anti-flash varnished to supply halogen spotlights for swimming pools and gardens with copper screen between primary and secondary.

Features

Dry type resin cast transformer

Advantages of resin technology:

- Protection against corrosive environments
- Protection against high vibration levels
- Protection against electrodynamic efforts
- Reduction of noise level
- Increase of product's lifespan

IP-54 enclosure in metallic box painted with epoxy resin

Safety class I

Includes LED functioning indicator, electrostatic screen and taps on primary according to distance between transformer and spotlight (100VA (10m, 20m, 30m), 300 VA and 600VA (10m, 25m, 40m)).

Possibility of tailor-made manufacturing

Downloads
