

Single-phase cast resin isolation transformers in IP54 enclosure, finished in anti-flash varnished to supply halogen spotlights for swimming pools and gardens with copper screen between primary and secondary.



### Technical characteristics

Rating	600 VA
Input voltage	230 V
Output voltage	12,5 - 13 - 13,5 V
Frequency	50/60 Hz
Protection degree	IP-54
Cooling	ANAN
Ambient temperature	45 °C
Temperature rise	Class B - 130°C
Insulation	Class H - 180°C
Windings	Class HC - 200 °C
Test voltage	3 kV (1 min, 50 Hz)
Standards	IEC/EN/UNE-EN 61558, CE
Mounting	Screws
Weight	11,9 kg

### Electric scheme

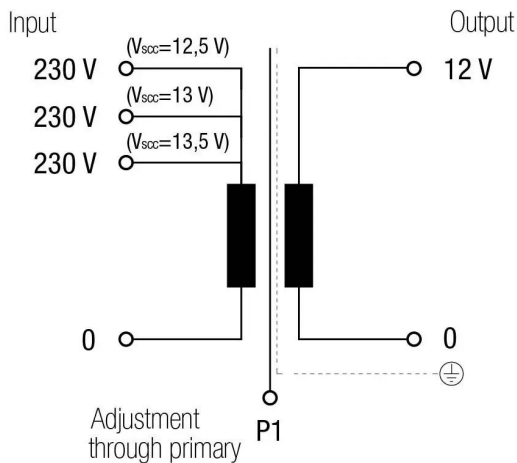

### Dimensions

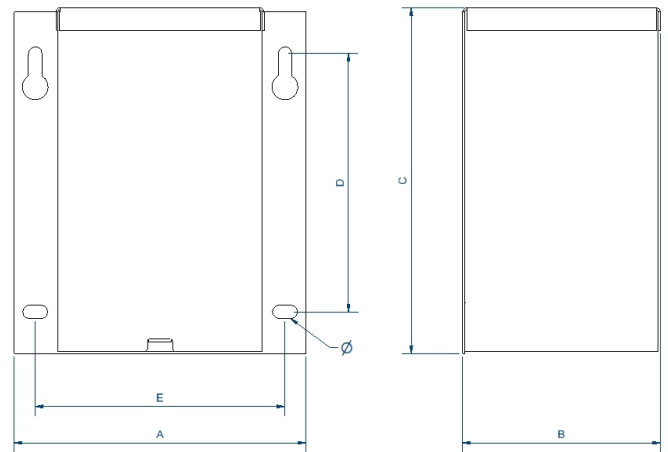

Dimensions (AxBxCxDxE): 190x120x215x174x160 mm 6Ø

### Electrical connection

1	2	3	4	5	6	7	8
0V	40m	25m	10m	0V	12V	0V	12V
Entrada 230V				(300 VA)		(300VA)	
<b>POLYLUX</b>		<b>600 VA</b>		50 - 60 Hz			
				EN 61558			
S.N.:XXXXXX				PIPZ600			
PRECAUCIÓN: CONECTAR TENSIÓN DE ENTRADA ENTRE TERMINALES 1-2 o 1-3 o 1-4							

**PIPZ 600**

**Input:**

- 230 V (distance between spotlight and transformer 40 meters)
- 230 V (distance between spotlight and transformer 25 meters)
- 230 V (distance between spotlight and transformer 10 meters)

- Connection: 1-2
- Connection: 1-3
- Connection: 1-4

**Output:**

- For one spotlight:
  - 12 V | Connection: 5-6 o 7-8
- For two spotlights:
  - 12 V | Connection: 5-6 y 7-8

Single-phase cast resin isolation transformers in IP54 enclosure, finished in anti-flash varnished to supply halogen spotlights for swimming pools and gardens with copper screen between primary and secondary.

## Features

---

Dry type resin cast transformer

Advantages of resin technology:

- Protection against corrosive environments
- Protection against high vibration levels
- Protection against electrodynamic efforts
- Reduction of noise level
- Increase of product's lifespan

IP-54 enclosure in metallic box painted with epoxy resin

Safety class I

Includes LED functioning indicator, electrostatic screen and taps on primary according to distance between transformer and spotlight (100VA (10m, 20m, 30m), 300 VA and 600VA (10m, 25m, 40m)).

Possibility of tailor-made manufacturing

## Downloads

---