

(1 : 35)

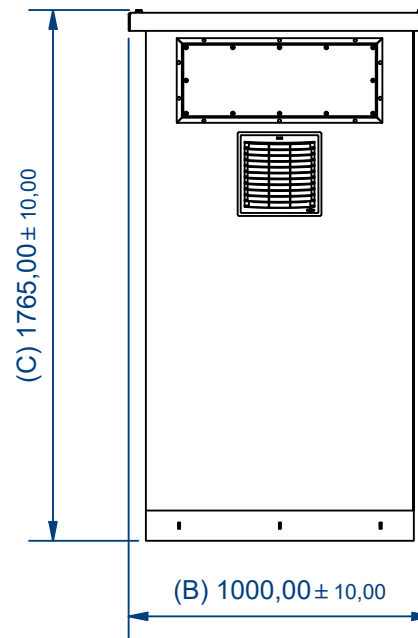
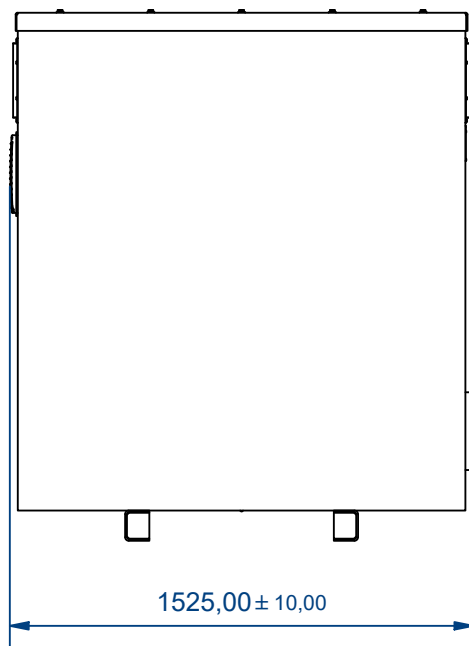
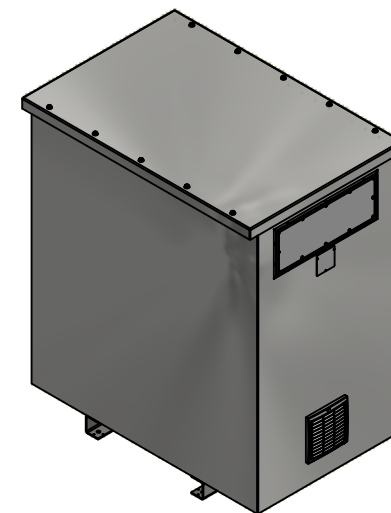

TOLERANCES ACCORDING TO EN 22768 mK		
MESURE(mm)	LINEAL TOLERANCE(mm)	ANGULAR TOLERANCE
≤ 3	±0,1	±1°
3<x≤ 6	±0,1	±1°
6<x≤ 30	±0,2	±30'
30<x≤ 120	±0,3	±20'
120<x≤ 400	±0,5	±10'
400<x≤ 1000	±0,8	±5'
1000<x≤ 2000	±1,2	±5'
> 2000	±2	±5'

Drawn by: OPS-14/04/2025	Modified by: EPS-02/12/2025	Approved by: AMR-02/12/2025	Surface treatment: RAL7035	General tolerances EN 22768 mK	DIN: A4
			Drawing reference: PP95RC150-TP5401		Units: mm
			Scale: 1 / 25		Page: 1 / 1
Description: General Dimensions			Technical D.	Customers	
			Commercial D.		